

WALL SYSTEMS

Armstrong DGS Wall Systems is a fast and easy solution for framing slim wall profiles and an economical alternative to Furring Channel battening.

Features

- Enables simple framing with fixing points at a maximum span of 1200mm centres.
- Easily self levels saving material and time.
- Enhances quality of finish and speed of construction by virtue of Wall Mouldings at the perimeter.



Components

Main Bar: PeakForm 38 with Knurled Face and SuperLock Clip (bulb-to-bulb connection)

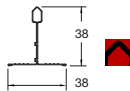
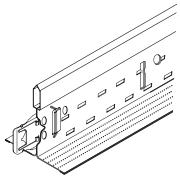

Item Number	Dimensions			Rout Spacing mm	Content / Carton / Weight		
	length (mm)	height (mm)	face (mm)		pcs	lm	kg
BP 794033	3600	38	38	150cc	12	43.2	24

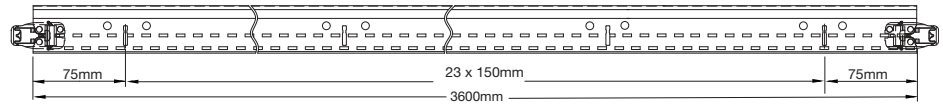

ShortSpan Tee with Knurled Face

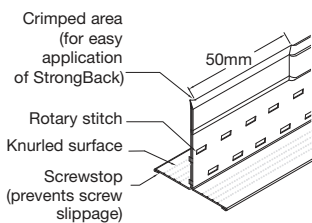

Item Number	Dimensions			Rout Spacing mm	Content / Bundle / Weight		
	length (mm)	height (mm)	face (mm)		pcs	lm	kg
BP 79S36	3600	38	38	—	12	43.2	20

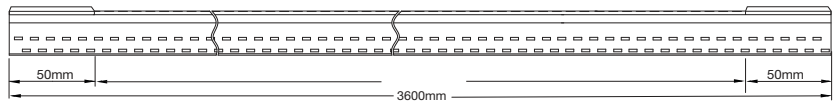

Perimeter Trim

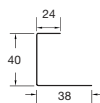

Item Number	Dimensions			Rout Spacing mm	Content / Bundle / Weight		
	length (mm)	height (mm)	face (mm)		pcs	lm	kg
Knurled Channel Moulding (hemmed with Knurled lower leg) BP KCM 36	3600	40	38	—	12	43.2	15.6

WALL SYSTEM

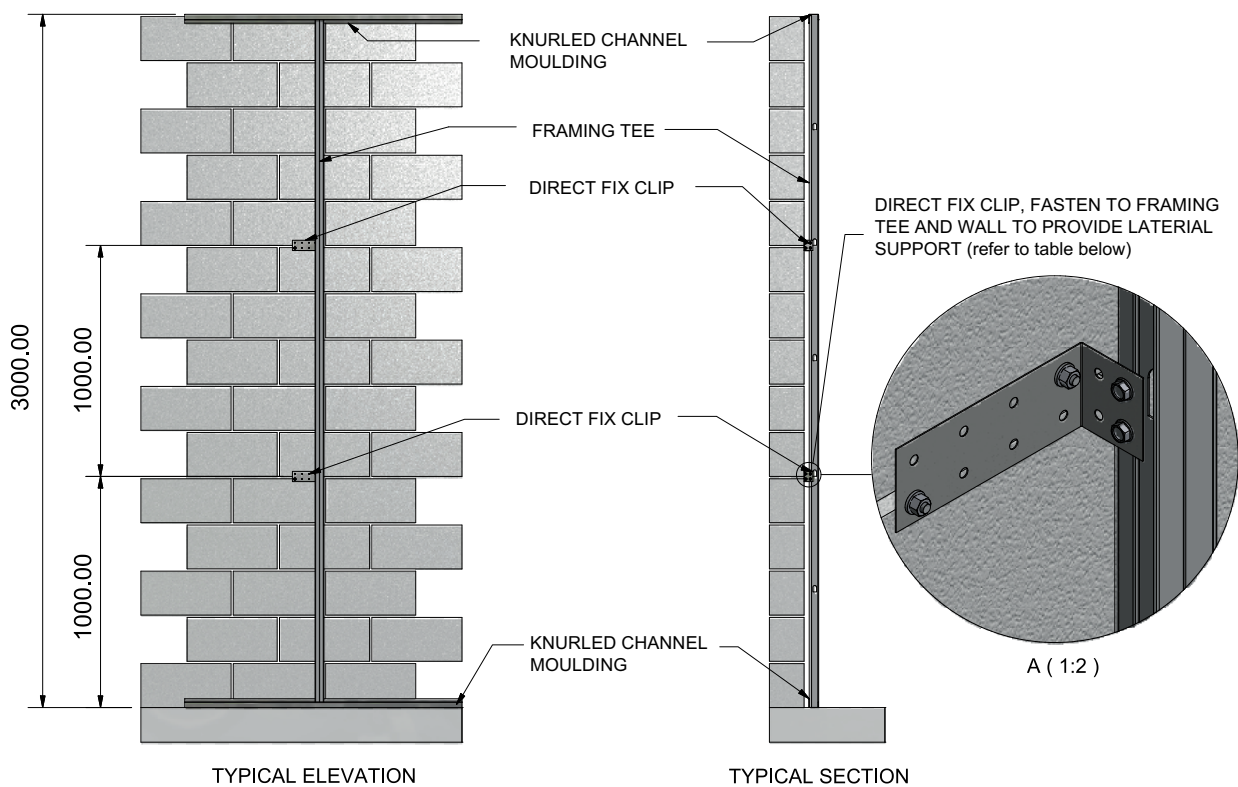

Wall System Clip Spacings

Main Bar Length	Maximum Anchor Spacing
2400mm	1200mm centres
2700mm	900mm centres
3000mm	1000mm centres
3600mm	1200mm centres

Design based on items below

BP794033	3600mm Main Bar
BP79S36	3600mm Shortspan

Installation Guide

The Armstrong Wall System is unique as the primary component is a 38mm Flat Face Tee which can be installed very quickly without requiring any adjustable clips to level your wall.

- Step 1.** Locate and fix the Channel Moulding top and bottom.
- Step 2.** Cut the Short Span 38mm Flat Face Main Bars to length and install at required centres (to suit your building board); screw fixing to Chanel Mouldings. This method will aid the wall system leveling.
- Step 3.** Screw brackets to both the structure (as per Design table), and to the ShortSpan Main Bars.

Locating Insulation

The DGS Wall System allows insulation to be installed easily, and the "Tee Bar" profile holds the insulation in place.

GRID ACCESSORIES

LEGEND: ● Flat Ceilings, ● Wall systems, ● Curved Ceilings, ● Quikstix Bulkheads, ● ShortSpan

Application

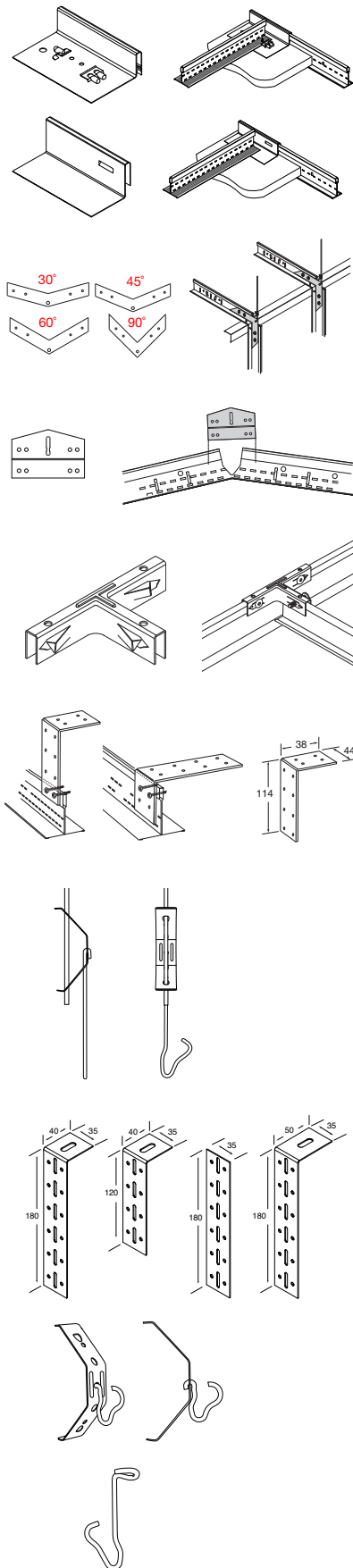

Item Number	Product Description	Pcs / Bucket	Legend
BPDW10LT BPDW13LT BPDW16LT ALDW13	Transition Clips with Locking Tabs facilitate transition from drywall to acoustical ceiling; one-sided hold-down clip; eliminates need for drywall bead. Locking tabs provide secure location for DGS tees For 10mm Plasterboard For 13mm Plasterboard For 16mm Plasterboard Suits 45/50 Top Hat for 13mm Plasterboard	125 125 125 100	● ● ● ●
BPDW30C BPDW45C BPDW60C BPDW90C	30, 45, 60 and 90 degree Drywall Angle Clips are used to create positive and secure angles for drywall and ceiling installations on either Main Bars or Cross Runners	250 250 250 250	● ● ● ●
BPRC2	Radius Clip is used to secure the Main Bar at the desired angle in curved ceiling applications. Includes a rout for Cross Runners installation	205	●
BPGC3W	3 Way Bite Clip connects Intersecting Cross Runners at any point along a Main Bar or other Cross Runners	250	●●●
BPQSUTC*	Up Tight Clip is used for Direct fix applications *Non stock item – lead time required	150	●●●●
SCDGS	Rod Hanging Clip is the standard height adjustable suspension clip connecting from 2.5 or 5mm rod to the DGS Main Bar	100	●●●
DWDFC DWDFC120 DWDFFC180 DWDFC18050	Direct Fix Clip – 180mm L Shape Direct Fix Clip – 120mm L Shape Direct Fix Clip – 180mm Flat Extension Direct Fix Clip – 180mm L Shape with 50mm Head	100 100 100 100	●●●● ●●●● ●●●● ●●●●
DGSSCS	DGS Suspension Clip Small is the standard height adjustable suspension clip connecting from 2.5 or 5mm rod to the DGS Main Bar	100	●●●
DGSSCTR	DGS Threaded Rod Clip is a suspension clip for 6mm Threaded Rod	100	●●●

ARCHITECTURAL SPECIFICATIONS

Wall Battening: Wall framing shall be Armstrong Drywall Grid System, comprising of ShortSpan, or Main Bar, including Knurled Channel mouldings, as per manufacturer's instructions.

Contact your Armstrong Office for additional project specification details.

TECHNICAL DATA

Features

- **PeakForm**
Patented profile increases strength and stability for improved performance during installation
- **Knurled Face**
Positive screw penetration into tees
- **ScrewStop**
Reverse hem prevents screw spin off on Tee face
- **38mm Wide Face**
Main Bars and Cross Runners – easy installation of screw fixed plasterboard sheets
- **Rotary stitched Double Thickness Web**
For additional torsional strength and stability

General Benefits

- Reduced installation time
- Reduced labour costs
- Reduced material costs and wastage
- Low 38mm profile across one plane
- Material off cuts can be used for bracing and as an alternative suspension method

Physical Data

- Material: Hot dipped galvanised steel
- Recycled Content: 25%
- Surface Finish: Z275 galvanised
- Main Bar / Cross Runner Interface: Joggled ends
- End Detail:
 - Main Bar: staked-on SuperLock clip
 - Cross Runner: staked-on XL² clip

Code Compliance

Armstrong DGS is designed and manufactured to comply with the following standards:

- AS/NZ 2785-2000: Suspended Ceilings – Design and Installation
- AS/NZ 2589-2007: Gypsum linings – Application and finishing
- AS/NZ 1397-2002: Steel sheet and strip – Hot-dipped zinc-coated or aluminium/zinc-coated
- AS/NZ 4600-2005: Cold-formed steel structures
- AS/NZ 1170-2002: Structural Design Actions

For Seismic
Design support
please contact your
local Armstrong
office.

Armstrong, the Global Leader in Acoustic Ceilings

NSW

Armstrong World Industries Pty. Ltd.
99 Derby Street,
Silverwater NSW 2128

Telephone (02) 9748 1588
Facsimile (02) 9748 8449

VIC/TAS

Armstrong World Industries Pty. Ltd.
29-39 Mills Road,
Braeside VIC 3195

Telephone (03) 9580 9633
Facsimile (03) 9587 5139

QLD/NT

Armstrong World Industries Pty. Ltd.
6 Barrinia Street,
Slacks Creek QLD 4127

Telephone (07) 3809 5565
Facsimile (07) 3809 5507

Printed on Zanders Mega Recycled paper
©2015 Armstrong World Industries Pty Ltd.
AWP1015

www.armstrongceilings.com.au

Inspiring Great Spaces™

Armstrong®

CEILING SYSTEMS